



# BIG SAVINGS

## EQUIPMENT AND SUPPLIES

Handle Complete Lines of ALL of the top makes plus having the LARGEST Inventory of fine quality Jewelry Making Tools and Supplies.

FREE CATALOGS AND BROCHURES

# THE SWENSONS

9641 E. Apache Trail  
Mesa, Ariz. 85207 (602) 986-4394

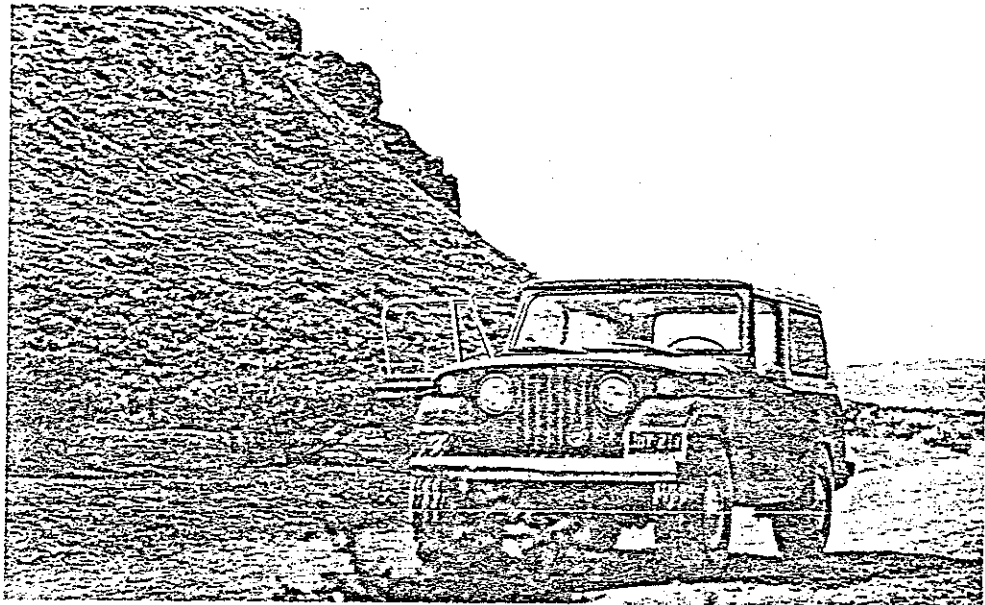

Eagle's Nest cliff is on the left. Petrified wood and oolite are found in their original deposits on top of the hill. All along the base and sides of this cliff are pieces of oolite, flints, and occasionally petrified wood. Look for arrowheads on the right. Two older abandoned gravel pits are also on the right.

### GEM-POL \$37.50

Factory Direct  
Add 12 lb Postage  
Calif. res. add tax

Heavy duty diamond compound polishing machine. Hard masonite rolls. GUARANTEED. Dia starter kit \$19.95. Free Brochure. Dept. L  
RAN-CO PRODUCTS—Box 3293—  
Granada Hills, CA 91344

### NEW!

### THE **ROD** WAX RING MANDREL

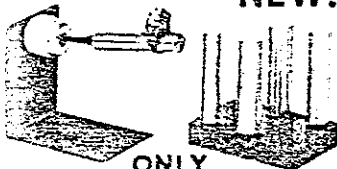

ONLY  
**\$1995** pat. pending

1. Human engineered to reduce fatigue factor.
2. Free swiveling in any direction.
3. Ball joint locks in any position.
4. Vertical or horizontal base positioning.
5. Mandrels easily removed for work change or inspection.
6. Generous 1 1/2" long steps each size.
7. Freely rotating mandrel.
8. Sizes 4 thru 13 supplied—other sizes available on special order.
9. Simplifies work handling and storage.
10. Right or left handed.
11. Satisfaction guaranteed.
12. Write for illustrated brochure.

F.O.B. LA PUENTE, CALIF.  
SHIPPING WEIGHT 1 1/2 LBS.  
CALIF. RESIDENTS ADD 5% TAX

DEALER INQUIRIES  
INVITED

MFG BY  
**THE **ROD** SHOP**  
15824 E. MAIN ST.  
LA PUENTE, CALIF. 91744

SEE DEMONSTRATION — BOURGET BROS. BOOTH — ANAHEIM JUNE 29 - JULY 2

Millions of years earlier great flows of lava and pumice ash embedded water-logged forests, eventually producing petrified wood. Hot water, laden with silica and other dissolved minerals percolated through beds of lava and sedimentary rocks, leaving nodules of agate, jasper, and flint. Sometimes it completely filled the empty pocket where a tree limb had weathered and dissolved out of the rock, leaving a perfect cast of the original limb. Oolite formed when ancient lake beds deposited small, spherical calcifications around organic or dust particles, to be finally covered or completely replaced by harder quartz.

It has taken millions of years to form some of these rocks. Agates are found in many colors and varieties, from milky chalcedony to banded, dendritic and crystalline, in many shades and colors. Petrified limbs are often found, excellent in color and grain formation. Jaspers, flints and cherts are common.

The flints and agates of these beach gravel deposits were favorites with the ancient people who lived here and used them to make tools and weapons. Undoubtedly the Indians who later lived in this valley used some of the more highly polished and beautiful stones as ornaments or charms. I have found them in old campgrounds among broken arrowheads and chips of flint and obsidian, many miles from places where they naturally occur.

The general area of these gravel pits may be the only place where exactly the right combination of agates and semi-precious gemstones was present in sufficient quantity, in conjunction with the polishing agents, to produce such beautifully polished beach pebbles. Of course it must be remembered that the stones were washed down in rivers and streams, and partially tumbled and polished before they reached their final resting places on the ancient beaches.

Judging from the amount of rock and

## Youngstown Ohio

### ROCKHOUND MACHINERY & SUPPLIES

AUTHORIZED DEALER

STAR DIAMOND

- SPECIMENS
- MUSEUM PIECES
- BAROQUE STONES
- BAROQUE FINDINGS
- CUTTING MATERIAL
- LAPIDARY SUPPLIES

SORRY  
NO  
CATALOG

- FLUORESCENT DISPLAY
- PROSPECTING EQUIPMENT
- WADDELL DISPLAY CASE
- BOOKS—MINERAL & LAPIDARY
- ARTICLES MADE FROM ROCK
- FLUORESCENT LIGHTS AND MATERIAL



### Adamas Lapidary & Gem Shop

8397 MARKET STREET - ROUTE 7 - 2 MILES SOUTH OF BOARDMAN  
2 MILES NORTH OF OHIO TURNPIKE INTERCHANGE 16  
PHONE 216 758-3185

HOURS: Open Mon. thru Sat 1-8 PM  
Closed Sun.

NOW YOU CAN HAVE QUALITY SOLID GOLD RING MOUNTINGS FOR YOUR PRIZED STONES BY FINISHING OUR CASTINGS AT A PRICE YOU CAN TRULY AFFORD.

Gold Castings

#### WE FEATURE:

1. 14 kt. and 18 kt. white and yellow gold
2. All ring sizes
3. All popular opening sizes including 18x13, 20x15, 25x18 mm.
4. Exquisite styling, many models to choose from
5. Average cost under \$20 for 14 kt., \$25 for 18 kt.
6. Send for FREE catalog
7. Satisfaction guaranteed



14 kt. — \$16.00  
18 kt. — \$20.00  
19x15 mm. No. 50

**A & R LAPIDARY** 1741 Alimingo Dr.  
Indianapolis, Ind. 46260

## DIRECT DELIVERIES FROM BRAZIL

Air parcels just 4 days to reach you.

for the highly skilled cutter

200 cts. pink and green Spodumene .....	\$ 10.00
200 cts. blue Topaz .....	\$ 20.00
100 cts. fine blue Aquamarines .....	\$ 40.00
100 cts. pink and green Tourmaline .....	\$ 40.00
Airmail and insurance .....	\$ 5.00
Order with check for .....	\$115.00

No stock list or catalog available. Minimum order \$25.00 please. Your check including air parcel post with order.

**MONEY BACK GUARANTEE**

**W. MARTIN BLUM & CIA. LTDA.**

P. O. Box 1974  
Sao Paulo, Brazil  
Rua 24 de maio, 276  
9th floor



## Ferris SEE-THRU MOLD COMPOUND

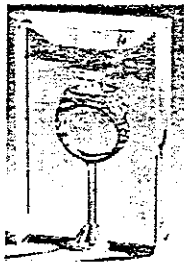

- NO PACKING
- NO MIXING
- NO VULCANIZER
- JUST POUR and BAKE
- IT'S TRANSPARENT
- SELF-LUBRICATING
- EASIER CUTTING

1 QUART COMPOUND 8.50  
(10-14 MOLDS)  
1 GALLON COMPOUND 25.50

## Ferris MOLD FRAME

Ideal For All

PAT. No. 3396934

"Pour Type" Mould Compounds

SIZE: 3" x 2" Available in the following thicknesses:

SIZE	PRICE	SIZE	PRICE
1/8"	\$6.00	1 1/4"	\$7.50
1/4"		1"	
3/8"			

PLUS HANDLING & TAX  
Order from Your Local Dealer

JEWELER AIDS, 130-40 227th St., Jamaica, N.Y. 11413

## MARDON ROCKS AND LAPIDARY, INC.

MANY OTHERS — SEND FOR LIST — RETAIL BY MAIL

Moss Agate .....	5 lbs.	\$ 3.00
Agatized Rhyolite Premium .....	3 lbs.	15.00
Rainforest Rhyolite .....	3 lbs.	7.50
Kullagh .....	3 lbs.	5.50
B. C. Jasper .....	3 lbs.	2.50
Pata De Gato .....	3 lbs.	3.00

Please Add Postage And Insurance  
Box 442, Mineola, New York 11501



The author has himself worked into a hole in search of snake agate.

the relatively large size of some of them, this was not a beach of the modern (post glacial) Harney Lake. The gravel appears to have been dropped into its present place by tremendous water forces operating thousands, if not millions of years before the recent geological times.

It is quite possible that this same combination of conditions and materials existed in other parts of Oregon and the Great Basin, although the gravel pits at the Narrows are the only place I know where these beautiful naturally polished pebbles are to be found. But then, who knows where else these same conditions may have produced something as good, or even better? Certainly countless thousands of pebbles still lie buried all along the former beaches in the same area where the diggings have so far unearthed them.

Perhaps the most satisfying experience of all is that of tracking down these stones to their source. After I had spent some time examining the gravel pits and collecting specimens, I began hunting for the sources of these interesting materials in the surrounding hills. I was able to locate the sources of some of the agates, petrified wood, oolite and flints. Since they can all be included in one field trip, I will describe them in the sequence in which you would encounter them.

### How to Get There

Leave Burns on Highway 78 East, and turn south at a well marked intersection about a mile and a half east of Burns. You turn onto State Highway 205, which leads to Frenchglen, Fields and Denio. A sign at the turn directs you to the Malheur National Wildlife Refuge. The road is paved, and mile posts are measured from this intersection, not from Burns.

The first landmark you reach is a high, narrow ridge sticking out into the valley, capped with a dense lava flow, and known as Wright's Point. At the top of Wright's Point you can pull off the road and survey the vast extent of Harney Valley beyond. All of the collecting points except Saddle Butte are visible from this vantage point.

Ahead and on your right you will see a mountain slightly higher than Wright's Point, named Dog Mountain. About midway along the base of the highest part of the mountain, several miles south, you can see a ranch house and possibly some evidence of digging. This is the Clyde This-

(Continued on Page 542)

**Diamond Products**

**DIAMOND DRESSERS**

- #60 3 ct. DIAMOND DRESSER complete with Jig Block \$10.50
- #62 3 ct. DIAMOND DRESSER complete with Jig Block \$13.95
- #65 7 STONE CLUSTER complete with Jig Block \$15.95

**DIAMOND POWDER** Approx. 1/2 oz.

PURE NATURAL UNGRADED DIAMOND POWDER IDEAL FOR POLISHING, LAPPING, ETC. USE AS IS OR GRADE YOURSELF. MESH SIZE APPROX. 270 TO VERY FINE

NATURAL UNGRADED DIAMOND POWDER \$1.25 per gram  
A Gram Weighs 28.35 Grains

**DIAMOND COMPOUND**

FINEST GRADE	COMPARES TO	USES STANDARD
Color	Size	Mesh Size
1 Lt. Gray	60,000	5 2.25
2 Ivory	14,000	2.25
3 Yellow	8,000	3.25
4 Orange	3,000	4.75
15 Blue	1,200	4.75
30 Red	600	4.75
45 Brown	325	4.75

\*Add for Postage\*  
All prices subject to change without notice.

**FREE**

4 CARATS OF NATURAL UNGRADED DIAMOND WITH EVERY ORDER OVER \$25.00 REFERENCING THIS ARTICLE.

We are an industrial diamond company and carry a complete line of diamond products. There is no competing your ordinary diamond work. Lapidary and jewelry available.

SINCE 1950 **INDUSTRIAL DIAMOND TOOL**

DEALER INQUIRES INVITED

DON'T YOU KNOW THAT YOU CAN CUT IT FASTER AND SMOOTHER WITH A HILLQUIST ROCK SAW?

Lapidary equipment by Hillquist is the finest available. Our 40 years of experience assure you of machines that will satisfy the demands of the most exacting craftsman. Send for our FREE catalog and see why these machines are preferred by professionals and hobbyists the world over.

**HILLQUIST**  
1545 NW 49th Dept. J Seattle, WA 98107

**QUEENSLAND GEMSTONES**

Selected Queensland Gemstone Rough Material including **OPAL**  
Export Price List available.  
Inquiries welcomed—Wholesale only please.

**R. J. HARRIS**  
General Agent and Exporter  
P. O. Box 125 16 Teneriffe Drive  
FORTITUDE VALLEY, TENERIFFE,  
Queensland, Queensland,  
Australia 4006 Australia 4005

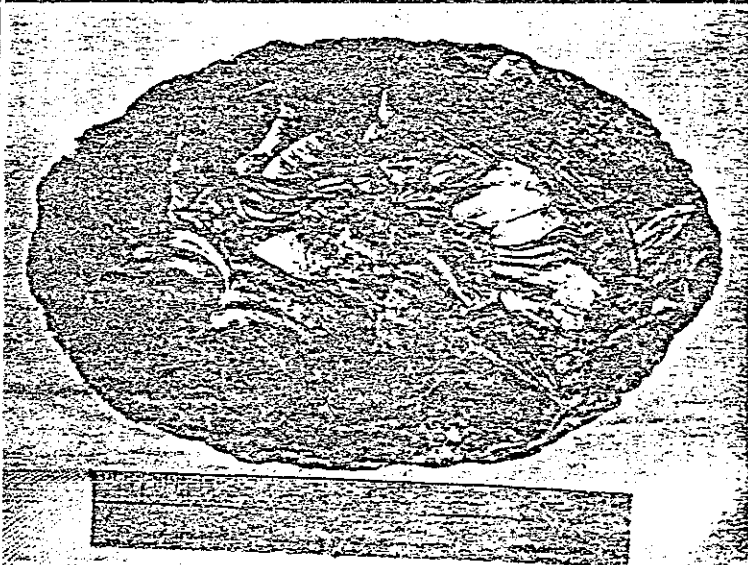
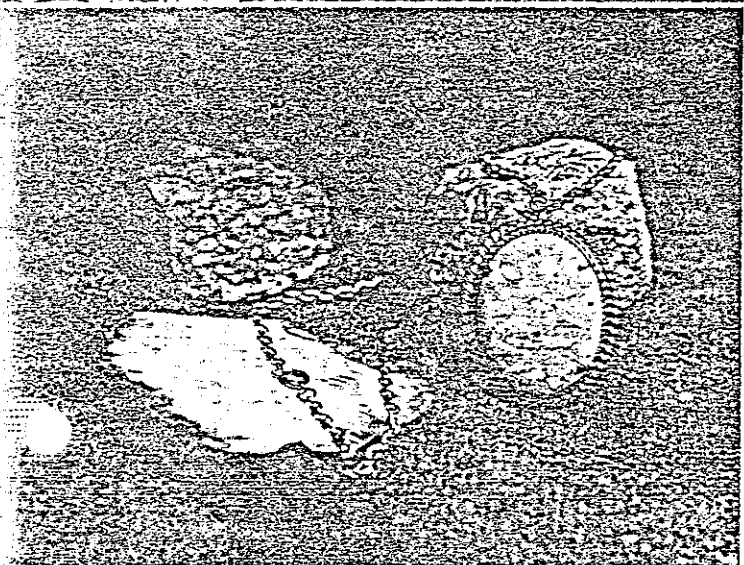
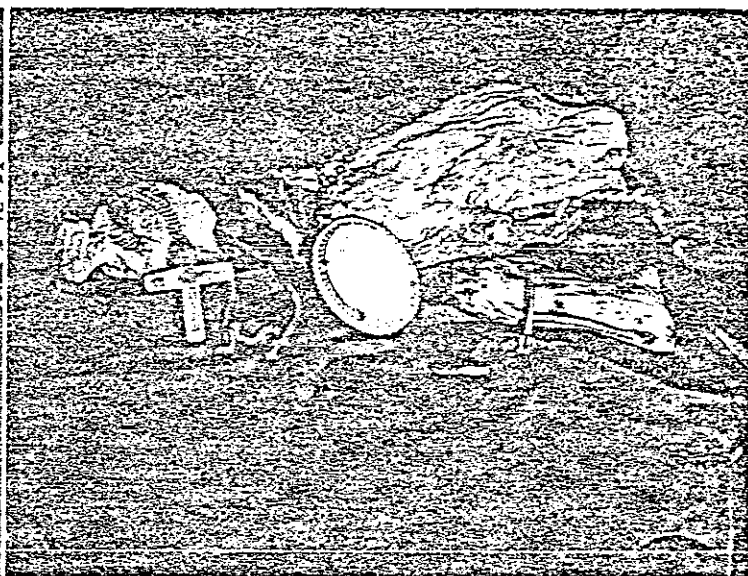
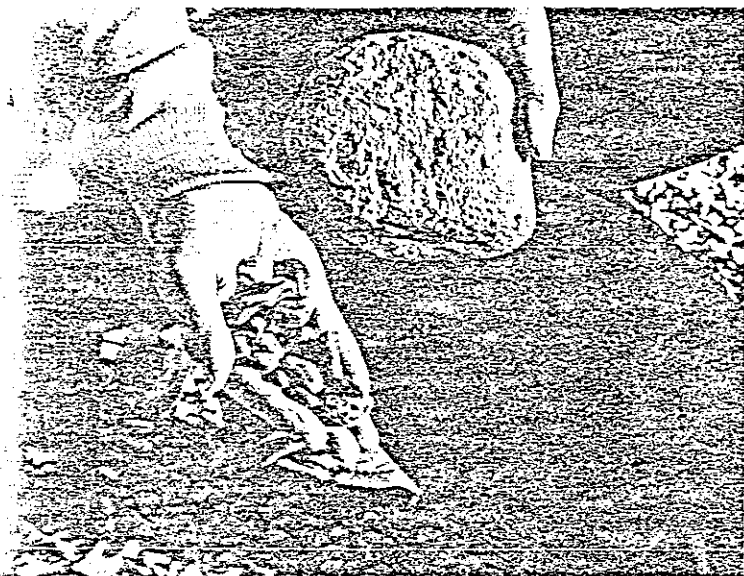

Top Left—A handful of polished “beach pebbles” in contrast with a piece of pumice foam. The handful of stones is heavier than the pumice, which will float on water.

Top Right—A cross cut from Snake Agate, against a piece of the natural stone, an oolite cabochon and a pendant of black petrified Eagle's Nest wood, along with a piece of raw wood and a partially tumbled limb.

Lower Left—Oolite from Eagle's Nest makes beautiful cabochons. Solid, dense pieces are well worth cutting and polishing.

Lower Right—This Harney County Indian artifact, probably a combination knife and scraper, is shown with a six inch ruler for size comparison.

### NEW YORK GEM TRIP IN A BAG

Beautiful red garnets in association with waste minerals and sand exactly as it was dug from pockets in rocks 500 million years old in the Adirondack Mts., N.Y. Not highgraded and untouched. You will find some clear, red garnets of gem quality in every bag, but nobody knows how many or what size until you wash and sort.

One Pound Sealed Bag ..... \$5.00 Postpaid & Insured (U.S.A. only)

#### TUMBLING GRADE ADIRONDACK GARNET

Gemmy deep red small—medium—large size mixed. Makes beautiful baroques. Lowest postpaid price anywhere

One Pound ..... \$1.95 (Minimum Order 4 lbs.) Postpaid & Insured.

#### BLUE FIRE FLASH MOONSTONE

A Scandinavia soda-rich microcline-anorthoclase variety composed of countless interlocking moonstone crystals ablaze with blue fire flashes. One inch thick slabs. For cabochons, ornaments and inlay work.

Three Pounds ..... \$6.95 Postpaid & Insured

MINERALS & GEMS

P.O. Box 5351

Albany, New York 12205

**INTER LOK IS A BETTER**

**DIAMOND BLADE**

**CONSTANTLY TESTED**  
**CONTINUALLY IMPROVED**  
**ALWAYS SUPERIOR IN CUTTING RESULTS**  
**MADE ONLY BY**  
**VANGUARD ABRASIVE DIVISION**  
**FEDERAL MOGUL CORPORATION**  
1875 AVENUE L, ROY, NEW YORK 14882

YOUR SPECIALIST (CUTTER AND DEALER) FOR ALL USUAL AND UNUSUAL (RARE AND SENSITIVE) GEMS:

**HANS W. LORENZ**  
UNIVERSAL CUTTERS

P. O. BOX 2583  
658 IDAR-OBERSTEIN 2  
W. GERMANY

The LAPIDARY WORKSHOP, Ltd.

Welcomes Drop In Trade  
New Rockhounds, Students,  
Friends — But puts out  
no catalog Come see us.

Julia & Bus Lovett

3418 Greenville Ave., Dallas, Texas



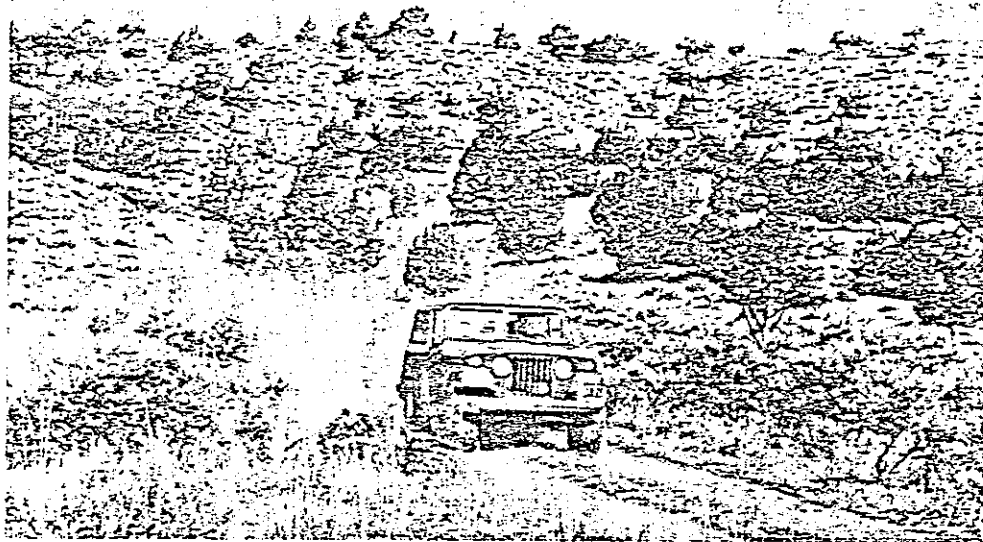

A closer view of the Snake Agate diggings with a rig coming out.

sell Ranch, and the site of the solid, milky chalcedony known locally as "snake agate." The name is a corruption of the term "snake skin," in which the outer surface of the stone has a pattern reminiscent of the scales on a snake's back.

The deposit is on private property, and the owner charges \$2.00 per person to dig, for six pounds of material; plus a charge of 40 cents per pound for anything over six pounds. The digging is fairly easy, however, and success is assured.

To reach the diggings, follow 205 south until you are at the south end of Dog Mountain, just past mile post 16. Turn right on a posted, gravelled road following a power line. After two miles, take another right turn (north) at a posted dirt road, and go another two miles along the base of the mountain until you reach the ranch house and the diggings. The owners will show you the most productive places to dig.

While you are still on Wright's Point, observe where the road disappears to the south over a low range of hills. At the base of the hills is the turn-off to the Malheur National Wildlife Refuge, to the left, just before mile post 24. The gravel pits are on both sides of the road to the east. The pit north of the road is the most extensive, and seems to yield the best polished stones.

Still on Wright's Point, look again at the distant hill where the road disappears. Notice that it ends in an abrupt cliff a couple miles to the right of the road. This cliff is called Eagle's Nest because eagles have regularly raised a brood of young in a nest high on the cliff. At the top of this cliff, and scattered all the way back on the hill as far as the highway, are extensive deposits of oolite and petrified wood.

To reach the top of the cliff, turn right on a dirt road a few hundred feet ahead of the turn to the gravel pits. Go about a mile and a half and follow the road around the base of the cliff and then up a steep, dusty hill on the back side of it. Before you reach the cliff, you will pass several older, abandoned gravel pits which are excellent digging spots.

On top of Eagle's Nest you will see  
(Continued on Page 544)

**Mountain View, Calif.**

**MILLTONS**  
181 CASTRO ST. VIEW SAN JOSE

**GEMS MINERALS SUPPLIES**  
MANUFACTURERS OF QUALITY MACHINES FOR THE LAPIDARY

And "Tumble Buffs" the ideal filler for your tumbler. Dealers write for prices.

**Windle's Rock Shop**  
Rt. 2, South on Hwy. 75  
Bartlesville, Okla. 74003  
Telephone 918-333-2814

**The Bishop**  
Finest of Lapidary Equipment

WRITE FOR FOUR COLOR FULL LINE BROCHURE

**BISHOP MFG. CO. INC.**  
714 RUBERTA AVE.  
GLENDALE, CAL. 91201

**LAPIS LAZULI ROUGH** (royal blue finest)

(Afghanistan) medium gem quality, \$17 lb., 10 lbs. \$130. Gem quality, \$27 lb., 10 lbs. \$2. The material is excellent for cutting, pieces average 1/4-1 lb. (2-6 lb. pieces available). 100% money back guarantee. Air postage and insurance paid. Send your order to: BEZALEL GEMS CO., 67/68 Hatton Garden, London EC1, England. (Big stock of cut gems, write for price list)

**KOHL'S ROCKS & MINERALS**  
932 Eubank N.E. Albuquerque, New Mexico 87112

**BOTSWANA AGATE**—South Africa—Beautiful fortification agate—Hen egg size and down—\$2.00 lb  
**FIRE AGATE**—Mexico—\$2.00 lb. No guarantees, very interesting material to work  
**HICKORYITE**—Mexico—Good solid material that takes high polish \$1.00 lb.  
Send \$5.00 and receive 1 lb. each of the above and we'll pay postage!

See 'ya at Grand Junction, Colo. June 3 & 4; Gem Village, Bayfield, Colo. July 15 & 16; Omaha Nebr. Sept. 2-4. Send for Free Price List.

**DE LAPA MINING INC.**

Suite 313 Wilson Bldg.  
Corpus Christi, Texas  
78401—512 884-4612

**GEMSTONES**

From its own mines De Lapa Mining, Inc., can offer a superior selection of faceted precious and semiprecious gemstones of the world. In particular, we can supply Alexandrite, Aquamarine, Amethyst, Andalusite, Beryl, Chrysoberyl, the Citrines, Emeralds, Morganite, Opals, the Quartz suite, and the Tourmalines.

**FACETERS: BEGINNING & ADVANCED**

Send 32c in stamps for facet rough catalog listing dozens of species, varieties and hues of facet roughs — Many rare and unusual roughs as well as a wide selection of the finest grades of familiar varieties.

**Sam Frost**  
THE MAYARD BLDG.  
175 CANADA ST.  
LAKE GEORGE, N.Y.

PHONE LAKE GEORGE, N.Y. NN8-5033  
AREA CODE 518

WRITE SAM FROST  
BOX 151  
LAKE GEORGE, N.Y. 12845

Devoted Exclusively To Supplying The Amateur With Professional Grade Faceting Rough

**GORIN'S GEM ARTS & ROCKS**

NEW GRAB BAG SPECIAL OFFER

For tumbling (\$12.00 value) 12 lbs. for \$8.00 postpaid. All mixed Mexican colorful agate for cutting (\$12.50 value) 10 lbs. for \$10.50 postpaid. Send self-addressed envelope for rock list.

4108 N. Piedras St., El Paso, Texas 79930 Tel: 915 565-2666. Rooms-lounge-Piedras 5 exit off Freeway. Quantity discounts to Dealers. El Paso's Complete Rock Shop.



Golden Green

# PERIDOT

ROUGH FACETING GRADE

Crystal Clear: (San Carlos, AZ)

4 to 6 cts.	\$ .40 ct
7 to 10 cts.	.60 ct
11 to 14 cts.	1.00 ct.
15 to 19 cts.	1.50 ct.

TUMBLE POLISHED  
FOR "GLUE-ON" JEWELRY

SIZE G-S	
2 oz.	\$ 4.00
4 oz.	8.00
SIZE G-M	
2 oz.	\$ 6.00
4 oz.	12.00

ROUGH TUMBLING GRADE

Under 1/4 inch	\$8.00 lb.
(The ideal size for "glue on" Jewelry)	
1/4 inch and over	\$12.00 lb.

POSTPAID

"SATISFACTION GUARANTEED"

Mrs. Arnita B. Sprague P. O. Box 1221,  
Apache Junction, AZ 85220

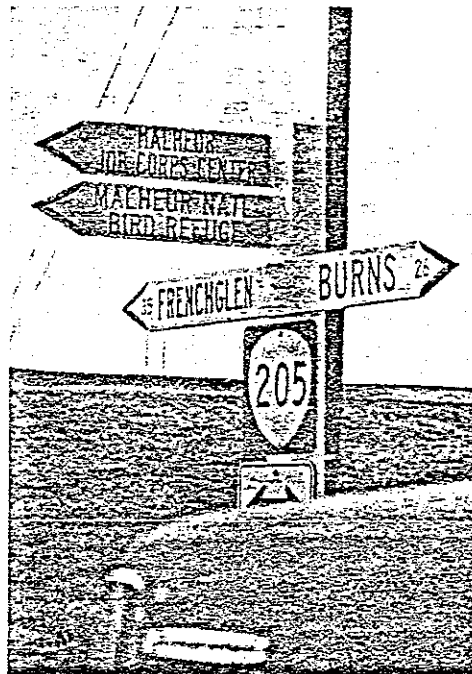

This sign identifies the turn off to the gravel pits, (left) and Eagle's Nest Hill (right).

where great quantities of earth and rock have been moved by eager rockhounds digging for the beautiful petrified wood, particularly small limbs and roots, which are found here. Good specimens of oolite used to be scattered all over the place, but now you may have to dig for it.

The petrified wood is not concentrated in this one spot, but logs and limbs have been found in an area covering many square miles. For instance, drive for exactly three miles on a dirt road leaving the base of Eagle's Nest, directly south, into the Salt Grass Hills. Here, in soft digging, you can find chunks of good quality flint and agate which often appear to be log and limb casts.

Your best bet in most of this area is to scout the surface for "float," and then try digging wherever you find it in ground that has not previously been dug. You will note that the original area on top of Eagle's Nest is under claim by the Stinkingwater Rock and Relic Club of Burns. The club took this precaution to prevent rock hogs from coming in with power equipment and other methods that quickly deplete the area. The club welcomes all legitimate rockhounds and trusts them to leave a clean camp, take only what they can use, and leave some for the next rock hunter.

You can reach other digging areas on the hill by following the pavement on up the hill south of the gravel pits. A jeep trail leaves the road on the right just past mile post 25, and another about three quarters of a mile farther on.

Another petrified wood collecting area, possibly part of the same formation as

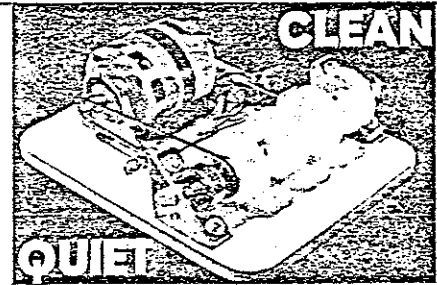

A polishing unit made especially for diamond compound. Plastic laps stay round, retain the diamond, do not "soak up" the compound. FREE brochure.

Price—with 4 laps 1 1/4" wide, \$50.90. Additional laps \$2.35 each. Shipping weight 16 lbs.

**DIXIE Star Products**

2324 1/2 North 16th, Boise, Idaho

STOP and BROWSE WITH DOWSE.

DOWSE'S ROCK & LAPIDARY SHOP  
UTAH'S FINEST

QUALITY & QUANTITY MATERIALS.

FIRE AGATE MEX. NEW FIND.	\$10.00 Lb.
Mex. Coconuts	\$ .40 Lb.
Mex. Agates, New red and yellow moss, some plumes	\$ .85 Lb.
Picture Stone (like Biggs)	\$ 2.00 Lb.
Fine Mex. Laces	\$ .85 Lb.
Pigeon Blood Agate, Utah 1 to 2 Lb. pieces	\$ 1.00 Lb.
Tumbling stones (Royal purple agate, Mex. lace, Utah pigeon blood) 5 Lb. mixed	\$ 4.00

Tons of material to pick from in our yard. Local and Foreign (India, Mexico, Brazil, Aust.). Large stock of Lapidary Equipment in stock at all times.

Please stop and look over our fine Materials. Be sure to add Postage. No orders under \$5.00.

**DOWSE'S ROCK SHOP**

754 North 2nd West, Salt Lake City, Utah 84103

## FOR SALE

A LAPIDARY COLLECTION  
THEY TALK ABOUT ALL OVER  
THE WORLD!

RETAIL STORE, SHOP, 3 AC,  
MUSEUM, 3 BDRM HOME.

ONLY \$130,000 WITH 1/2 DOWN.  
EVERYTHING INCLUDED!

**DEL ROQUE REALTY**

603 S.E. 6th Street  
Grants Pass, Oregon  
503-476-7040

## WAN DAH JADE & CORAL FACTORY CO.

TAIWAN JADE & CORAL JEWELRY  
CARVINGS & LOOSE STONES  
WHOLESALE

Head Offc P. O. Box 1743 Taipei, Taiwan  
Branch Offc P.O. Box 74213 Los Angeles, CA 90004

## NEW MIZZY

Heatless mini grinding wheels as recommended by Quick's Gem. Excellent for rapid cutting on metal, ceramics, wood, glass. Fits all standard arbors. Available in 15 sizes. 5 diameters—1/2" to 1" and 3 thicknesses—3/32" to 3/16".

One dozen assorted sizes \$2.15



### COLORFUL MINERAL IDENTIFIER

by Anthony C.  
Tennison, Ph.D.

Pocket Size Hard  
Bound - Full Color

This book gives full identification in the field or common minerals including Physical Properties, prominent locations plus a full color plate of a typical example of each variety. Photography of excellent quality by Werner Lieber.

T3-810 \$3.50 each

**BASKIN & SONS INC.**

32 UNION AVE. MIDDLESEX, N. J. 08846



### FREE CATALOG

if today

Minimum 2 lbs. per order  
Postage must be included

**WORLD WIDE GEMS**

145 North Rose, Kalamazoo, Mich. 49006



### SPECIAL FOR MONTH

Kona-Dolomite (pink & black picture rock)—\$2.50 per lb.  
Green Moss Agate—\$2.00 per lb.  
Petrified Algae—\$2.00 per lb.  
Tolteca Coconuts (new)—\$1.00 per lb.

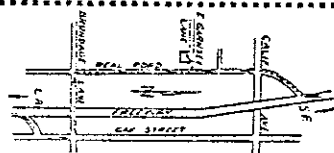

**ONLY TWO BLOCKS FROM FREEWAY**

THOUSANDS of Cabochon and Flat slices  
 THOUSANDS of Crystallized Mineral Specimens  
 Mountings - Materials - Supplies - Equipment  
**HIGHLAND PARK EQUIPMENT on the Floor**  
 Inquire about our Cabochon instruction Course  
 Radically different, amazingly easy, no classes  
 Your choice of time, reasonably priced, terms.  
 Out-of-towners can complete course in 3 days  
 Everything for the Rockhound and Guaranteed

Open every day 10 to 6 except Mon. and Tues.  
**DEAN'S AGATE SHOP**

Authorized Phone 324-9179 Crown Mfg. Co.  
 Frantom Dealer 3427 Garnsey Lane Gemex Co.  
 Ultra-Violet Bakersfield, CA 93309 Myco  
 Products

Authorized **HIGHLAND PARK MFG. CO DEALER**  
**J.J. JEWELCRAFT Dealer**  
 (33 years in Lapidary - 26 years Lapidary Instruction)

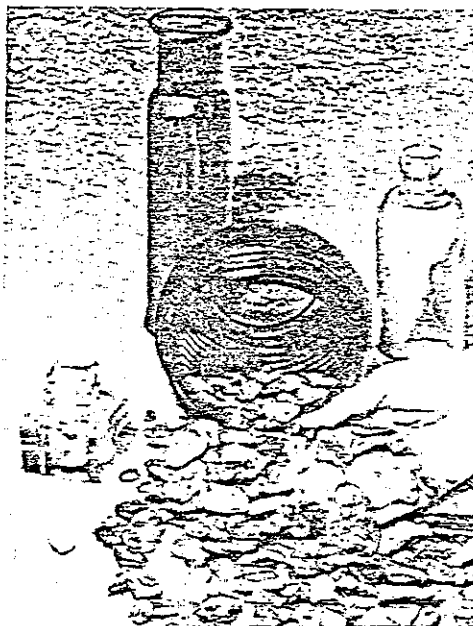

An assortment of naturally polished agates, oolites, flints and petrified wood just as they come from the gravel pits, along with some Harney County homestead artifacts.

the Eagle's Nest deposit, is at Saddle Butte. Follow the pavement on south from the gravel pits to mile post 32. Here you are exactly opposite Saddle Butte which is on the left of the road. Some good logs have been dug on the south flank of the butte. Follow the pavement to a jeep trail leaving the road to the left a short distance before you reach mile post 33. A State Highway gravel pile is opposite the turn. Petrified animal bones have been found in the walls of some gullies at the southern base of the butte.

In case you don't find anything on Saddle Butte, drive out on the flat past the gravel dump and scout for float. Some nice limbs and even fairly chunky pieces of weathered logs have been found out here on the flat under the power line.

Two things to watch for while you are rock hunting in this area are arrowheads and rattlesnakes. Both were much more common in the past than they are now, but you can still find both if you are on the watch. The snakes will stay out of your way if you make enough noise with your feet as you walk. They hear the vibrations in the earth, but not the sound waves in the air. So stomp your feet as you walk, and you will seldom, if ever, see a rattlesnake. The arrowheads are a different matter. They are even harder to find, but at least they stay put while you search for them. ☺

**ELIMINATE LITTER PLEASE**



**JEWELRY FINDINGS ALL METALS  
 EARWIRES - CHAINS - JEWELS**

WE SPECIALIZE IN BEADS  
 AUSTRALIAN OPALS - CORAL  
 PERSIAN TURQUOISE

Send For Catalog No. 4  
 OPEN MON. THRU SAT. 12-6 PM

**BEAD GAME**

505 No. Fairfax Ave, Los Angeles CA 90036

**\$4.00**



SEND FOR THIS  
**MINERAL AND GEM  
 HANDBOOK.**

It is a detailed and  
 informative catalog  
 of materials (facet-  
 ing and cab) as well  
 as mineral speci-  
 mens and crystals.

MAIL TO:  
**PARSER MINERAL  
 CORP.**

Box  
 2076,  
 Danbury, Conn. 06810

**WATCH THIS!**

**MAKE COASTERS - TILES - TRIVETS**

MIX STONES  
 AND EPOXY



LET SET—  
 SLICE THIN

— THEN —

**DIP SLAB IN POLYTHANE  
 FOR BRILLIANT—  
 INSTANT—  
 POLISH—**



Epoxy—\$20.00 for Two Gal.  
 Polythane—\$9.00 Per Gal.  
**F.O.B. WASHINGTON, D.C.**  
 Sample Kit—1 Qt. Epoxy and  
 1 Pt. Polythane \$7.50 P.P. U.S.A.

**PSYCH-ART**

4725 Linnean Ave., Washington, D.C.

**INDIAN STONES at  
 INDIAN PRICES**



Rubies, Sapphires, Emeralds, Star Rubies, Star  
 Sapphires, Rubies, Sapphires and Emerald  
 Beads; Also Beggar Beads, Bloodstones, Moss  
 Agate, Carnelian Agate Beads. Lots of 1000  
**AGATE CABOCHONS etc.**  
 Register on our mailing list and we will send you  
 FREE SAMPLE OF AGATE CABOCHONS.

**ADRIS ORIENTAL GEM  
 & ART CORPORATION**

565 FIFTH AVENUE  
 NEW YORK, N.Y. 10017  
 PHONE 212-986-0720  
 CABLE ADRISGEM



**LAPIDARIA DE  
 QUERETARO**

Gold or silver custom made mount-  
 ings to fit your stones.  
 Rough and polished Mexican and  
 Australian Opal.  
 Custom cabbing and faceting.

1526 3rd Street, Tijuana, B.C., Mexico

**THE  
 ROCIPROLAP**

Lapping and  
 Polishing  
 Machine

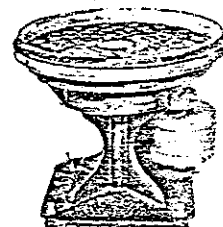

Operates automatically with a minimum of at-  
 tention for the finest in flat lapping and polish-  
 ing. NOT A VIBRATING MACHINE — THE LAP  
 PLATE REVOLVES AND RECIPROCATES SIMUL-  
 TANEOUSLY. Constructed to industrial Stand-  
 ards for both industrial and lapidary work  
**ALL CAST-IRON AND STEEL**

18", \$209.50 — 20", \$227.50  
 (F.O.B. Bakersfield, Calif.)

**ROSE ENTERPRISES — Designers & Mfrs.**  
 3217 Annapolis Dr., Bakersfield, Calif. 93305

**\$29.95**  
 F.O.B. TULSA

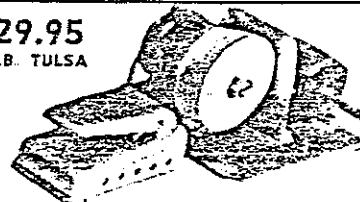

**Diamond Jubilee  
 DUBLEE**

4731 S. COLUMBIA PLACE  
 TULSA, OK 74105

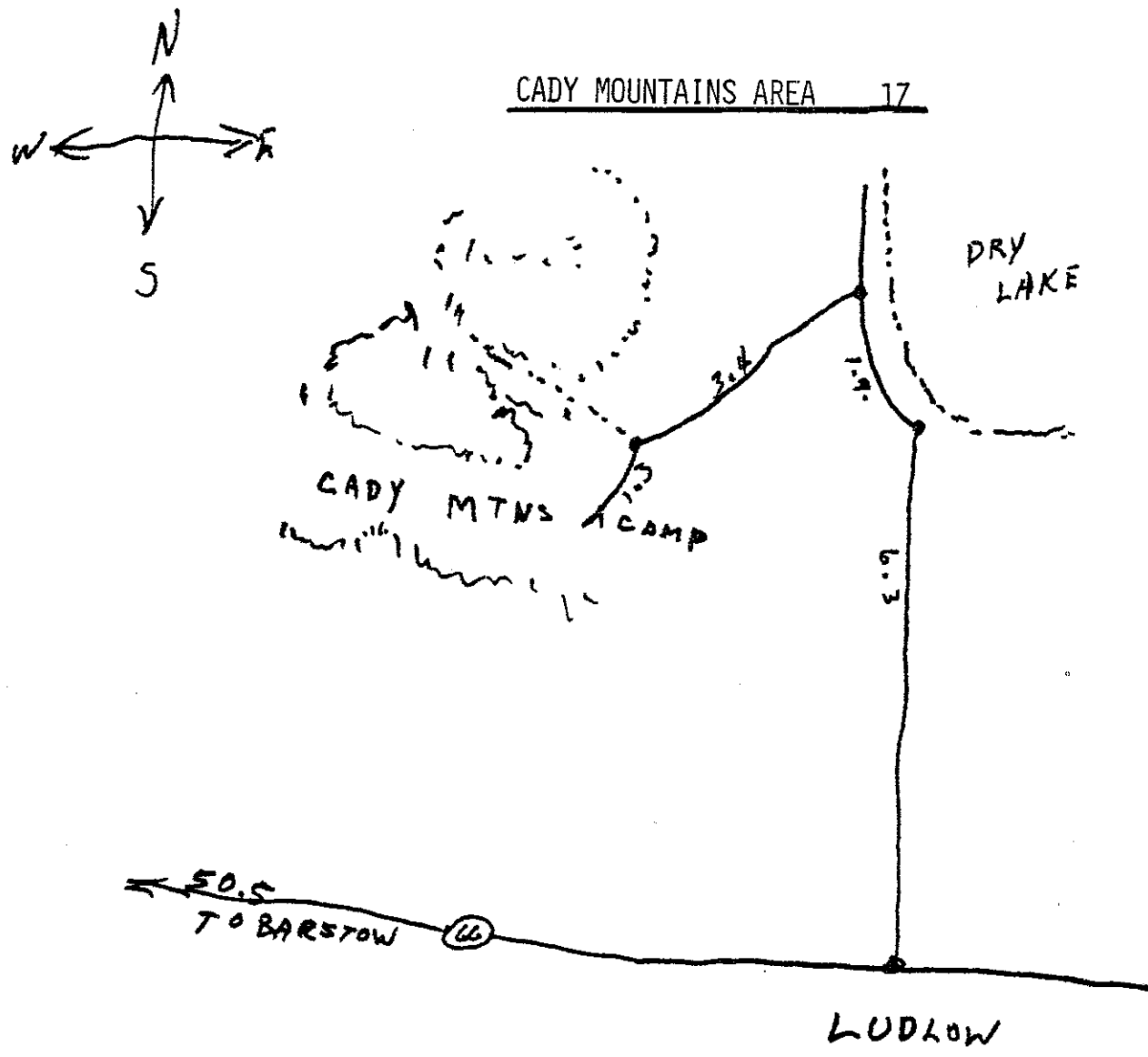

COLLECT: ROSEBUD AGATE AND....., THE CADYS  
 HAVE LOTS OF MATERIAL.  
 BRING: - HARD ROCK TOOLS - WATER  
 OK FOR STOCK CARS AND TRAILERS



When you go into the Cady's be sure and carry plenty of water and be careful of your tires.

The Lap map shows one of the oldest and still the best collecting areas for jaspers and jasp-agate to be found anywhere. All you have to do in several places is to drive a short distance from the highway, get out of the car and start picking up good materials. The bottom map shows a very good area for moss and lace agate, jasper and some plume agate. The directions for finding gem materials is as follows: Road branches at 11.8 mi. Left branch goes 100 ft. to camp site. Rt. branch goes .2 mile to base of hill. Bad twisty road. To reach gem field take wash right which reaches road at about 11.8 mi. and follow it about .5mi. keeping to right of low range of green hills. Go through narrow reddish cut and up a drainage channel that comes down from hills at left.

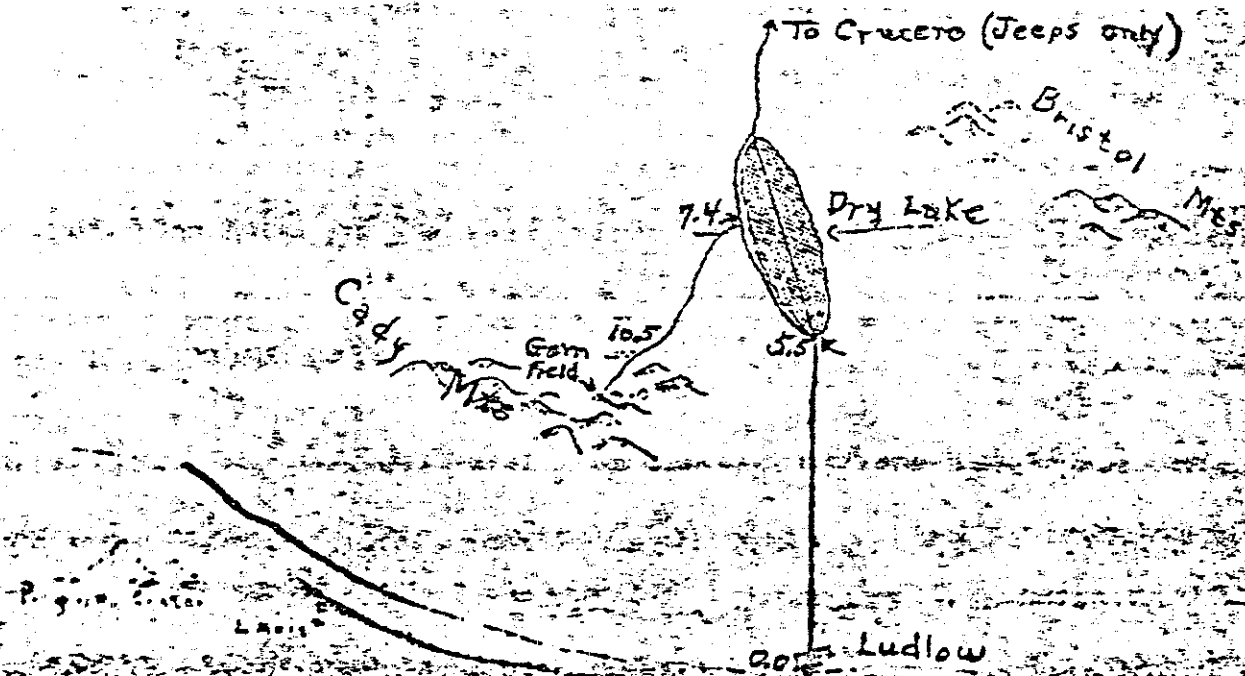
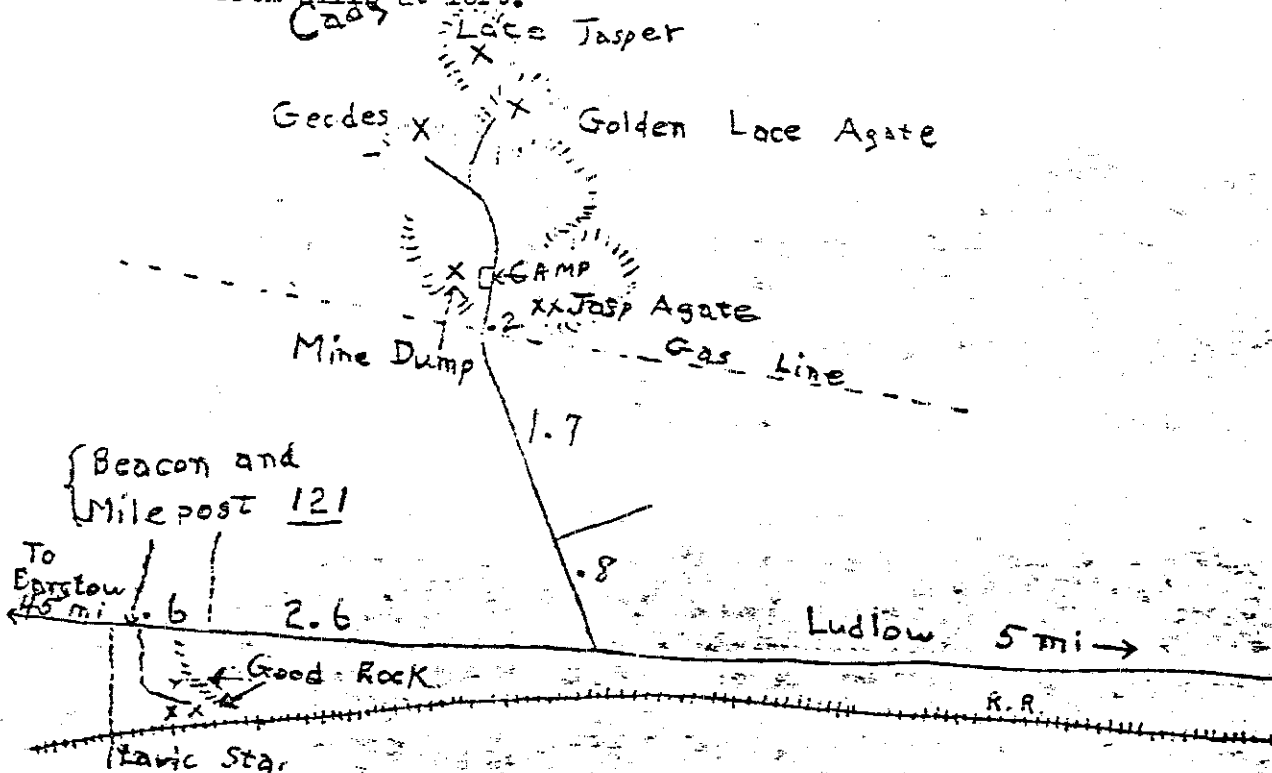

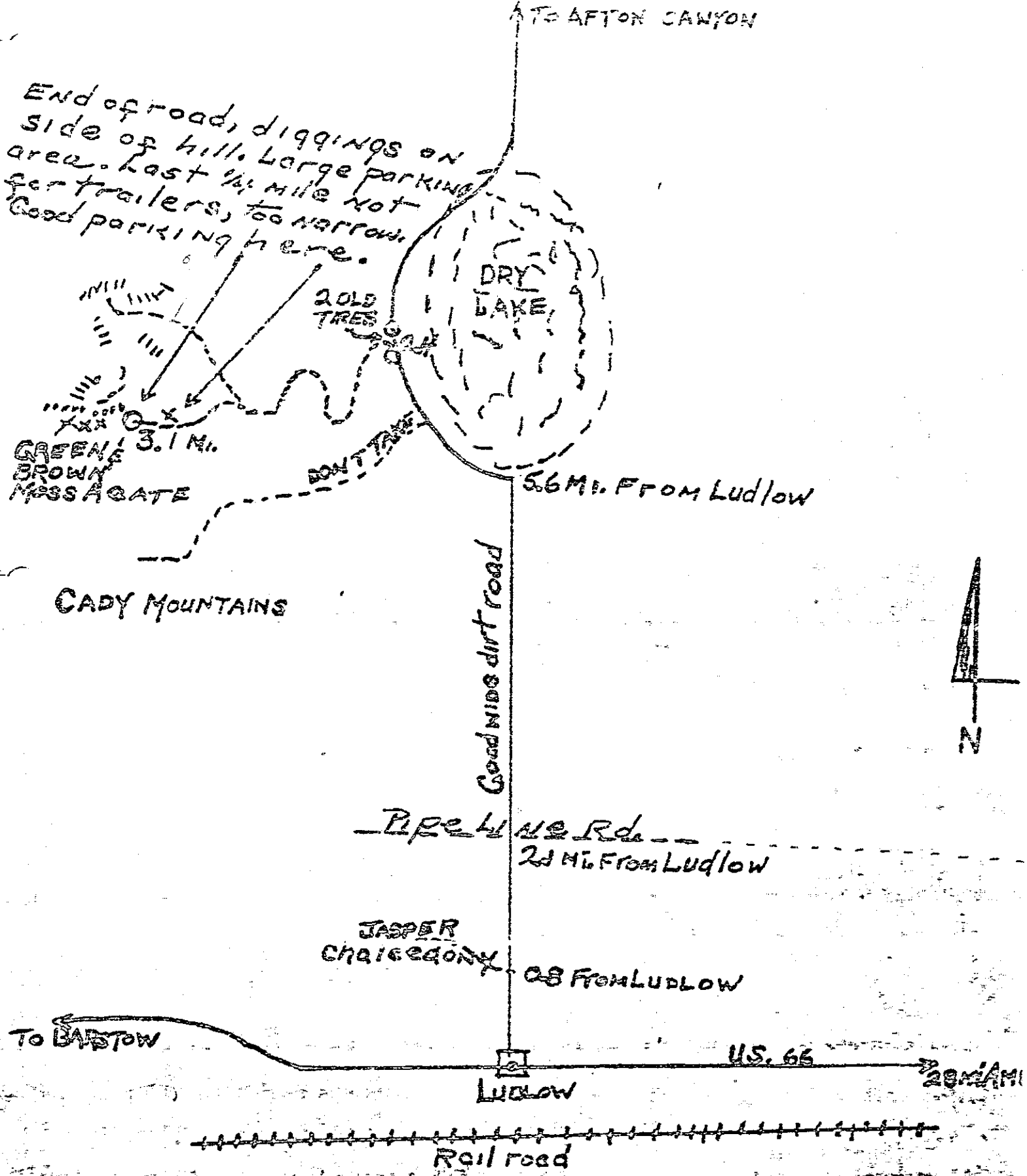

End of road, diggings on side of hill. Large parking area. Last 1/4 mile not for trailers, too narrow. Good parking here.

3.1 Mi.  
GREEN BROWN MASS AGATE

Good wide dirt road

DRY LAKE

OLD TREES

5.6 Mi. FROM Ludlow

CADY MOUNTAINS

Pipe Line Rd.  
2 mi. FROM Ludlow

JASPER CHACO CANYON  
0.8 FROM LUDLOW

TO BASTOW

Ludlow

US. 66

Rail road

